



Visit Our Web Site at www.zendextool.com

SPEED BLASTER®

GRAVITY FEED BLASTER

OPERATING INSTRUCTIONS / MODEL 007

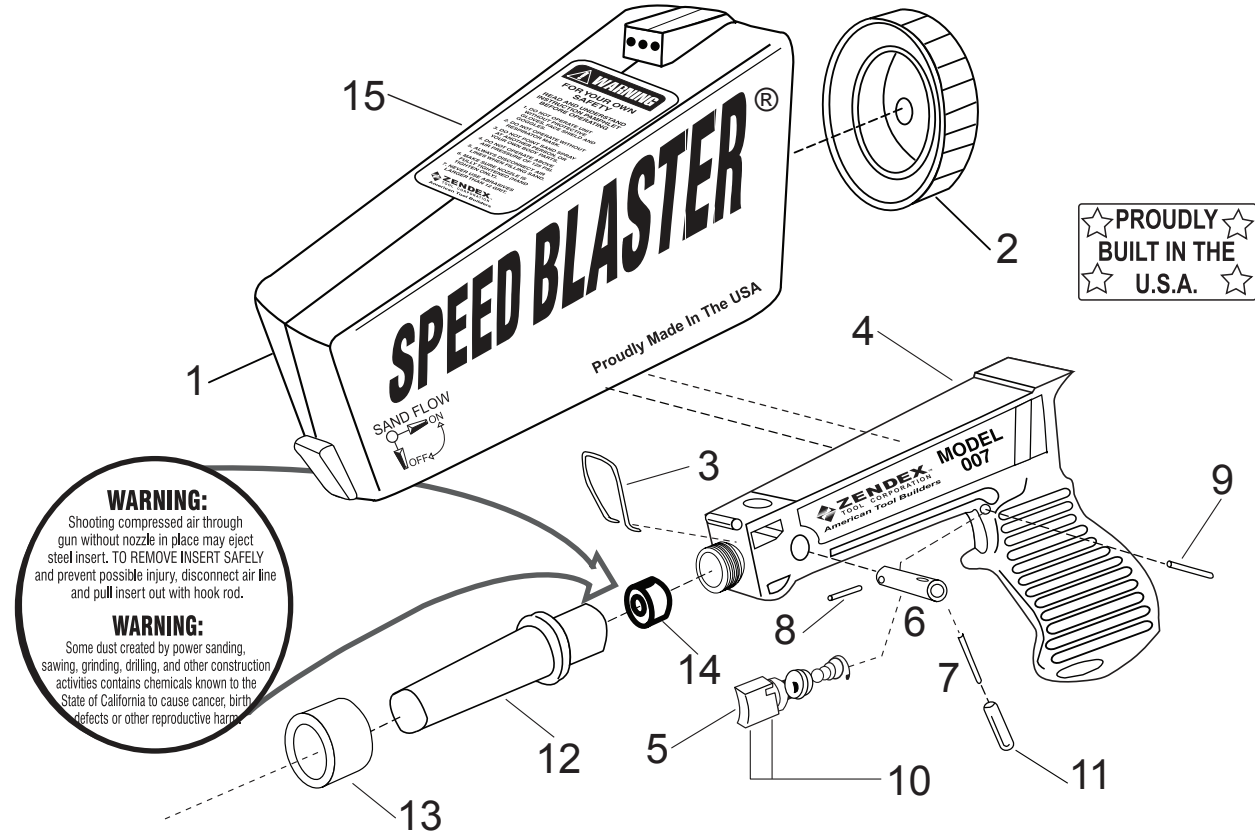

ITEM	PART #	DESCRIPTION
1	007-1R	Media Container-Red
	007-1W	Media Container-White
	007-1B	Media Container-Blue
2	007-2	Cap
3	007-3	Clip
4	007-4	Handle
5	007-5	Trigger Assembly
6	007-6	Control Valve
7	007-7	Roll Pin 1/8" X 1 1/4"

ITEM	PART #	DESCRIPTION
8	007-8	Roll Pin 1/8" X 5/8"
9	007-9	Roll Pin 1/8" X 1"
10	007-10	O Rings
11	007-11R	Rubber Cap - Red
	007-11W	Rubber Cap - White
	007-11B	Rubber Cap - Blue
12	007-12	Nozzle
13	007-13	Nozzle Retainer
14	007-14	Steel Insert
15	3025	Warning Label



4 Larson Drive • Danbury, CT 06810 U.S.A. • 800-446-5257 or 203-778-0400
 Email: support@zendextool.com • Web: www.zendextool.com • Social: @zendextool

PLACE
 STAMP
 HERE



4 Larson Drive • Danbury, CT 06810 • U.S.A.

WARNING:
Shooting compressed air through gun without nozzle in place may eject steel insert. TO REMOVE INSERT SAFELY and prevent possible injury, disconnect air line and pull insert out with hook rod.

SPEED BLASTER®

GRAVITY FEED BLASTER

OPERATING INSTRUCTIONS - MODEL 007

WARNING:
Some dust created by power sanding, sawing, grinding, drilling, and other construction activities contains chemicals known to the State of California to cause cancer, birth defects or other harm.

Recommended Operating Procedures

1. **Please send back your Warranty Card.** This card not only provides information on possible warranty issues, but will also alert you to new product upgrades that can make your work faster and easier.
2. Install a male 1/4" NPT pipe thread nipple of your choice in the handle base. Teflon tape is recommended to prevent air leaks. **Do not over tighten**, or there is the possibility of stripping the steel insert, or the gun handle, which constitutes abuse, and is not covered by the warranty. (no more than 20 foot pounds of torque is recommended).
3. Make sure the air line is disconnected, open lid and fill media container with media. (It is highly recommended that the media used is specifically made for blasting purposes) and replace lid securely.
4. Put on eye protection, face shield, gloves, respirator mask, and a rubber coat...**Now you're ready to blast!**
5. Set air pressure at regulator to no more than 125 P.S.I. **Make sure the air delivered is clean and especially dry.** No Blaster will work effectively with moisture laden air. **UNIT WILL NOT WORK CORRECTLY OVER 125 P.S.I.**
6. Open media flow valve to desired position. Place ceramic nozzle at a comfortable distance from part to be blasted, approximately 6 to 24 inches is recommended. The distance from the part to be blasted will determine the pattern. The closer to the part, the smaller the pattern.

TROUBLE SHOOTING

1. Media Flow Stops:

- A. Air delivered may contain moisture. Make sure proper water separator is installed.
- B. Check air pressure (Minimum 60 PSI required).
- C. Remove front clip on reservoir, lift and swing reservoir slightly and check orifice in material control valve. If obstructed, remove debris and reassemble.
- D. Make sure nozzle is fully tightened (**Hand Tighten Only**). Make sure there are no particles between the steel insert directly behind the nozzle and the body of the gun. If necessary remove the steel insert and blow out the carburetor to remove any media or debris that may be lodged in this area. (Make sure to wear safety goggles).
- E. Remove nozzle to see if the steel insert is lost or missing. **SPEED BLASTER WILL NOT WORK WITHOUT THE STEEL INSERT IN PLACE.**

2. Media Pattern Erratic:

- A. Air delivered may contain moisture. Make sure a proper water separator is installed.
- B. Blast media has inconsistent particle sizes and must be strained. Use a small pattern screen with maximum 1/16" openings.
- C. Nozzle is worn and must be replaced.
- D. **STEEL INSERT IS WORN OR LOST.**

© 2006 Zendex Tool Corp. All rights reserved. Specifications subject to change without notice.

Before operation, read and understand the warnings and operating instructions for the proper use of your **Speed Blaster**. **Speed Blaster** is a powerful tool and every precaution should be used for your own safety, as well as the safety of others.



IMPORTANT

Read and understand these warnings before operating Speed Blaster!

- WARNING:** 1. **DO NOT** operate Speed Blaster without face shield and eye protection. Media, rust, scale, paint, etc. can rebound from work being blasted and can cause serious injury, including possible blindness.
- WARNING:** 2. **DO NOT** operate Speed Blaster without protective gloves. Media particles travel at high speed and direct contact with hands and other skin parts can cause serious abrasion.
- WARNING:** 3. **DO NOT** operate Speed Blaster without a respirator mask. Inhaling dust and other airborne particles into lungs can cause a serious health hazard.
- WARNING:** 4. **DO NOT** point media spray at another person, animal, or your own body parts. Media particles can cause serious abrasions. Further, media spray can penetrate the average clothing, and cause injury as well.
- WARNING:** 5. It is recommended that a rubber rain coat or similar covering be worn to protect one from the blast media rebounding, and from over spray.
- WARNING:** 6. **DO NOT** operate Speed Blaster at air pressure above 125 PSI (Pounds per Square Inch).
- WARNING:** 7. **DO NOT** fill media reservoir while compressed air line is still attached to Speed Blaster. Accidental squeezing of the trigger can activate media spray while Speed Blaster is aimed at self or others, causing serious injury.
- WARNING:** 8. Make sure ceramic blast nozzle is fully tightened when in use. (hand tighten only). There is a small steel carburetor insert directly behind the ceramic nozzle that is held in alignment by the nozzle. If this insert is not aligned properly, media will not flow.
- WARNING:** 9. **DO NOT** use abrasive media larger than 14 grit. Proper blast media should always be used in your Speed Blaster. Larger particles will clog the media flow control valve and cause faulty or sporadic operation.
- WARNING:** 10. **DO NOT REUSE MEDIA** unless it has been strained through a fine screen strainer (pattern not to exceed 1/16"). particles larger than the recommended 14 grit will clog media flow valve.
- WARNING:** 11. **MAKE SURE** the media control valve is in the off position before connecting the air line to Speed Blaster. Accidentally depressing the trigger with the media flow valve open, will immediately initiate the blast mode.

WARRANTY REGISTRATION CARD

MODEL 007

Please return this warranty and product update registration or register online at <https://zendextool.com/warranty/>

Purchased from _____

Purchaser _____

Address _____

City _____ State _____ Zip _____

This Speed Blaster you have purchased is warranted to be free of defects in material and workmanship under normal use for a period of one year from user purchase. (Ceramic nozzle is a wear item and is not covered under warranty).

Any Speed Blaster or component claimed to be defective during warranty period must be returned to Zendex Tool Corp.; transportation charges prepaid. The product must be properly tagged, stating the nature of defect, customer's name, address and date of purchase.

Any product or component determined defective by the factory due to normal use will be repaired or replaced free of charge during the warranty period and returned freight prepaid.

Warranty is void if Speed Blaster has been subjected to neglect, misuse, careless operation or if alterations have been made.

Acknowledged _____ Signature _____ Date _____



4 Larson Drive • Danbury, CT 06810 • U.S.A.